

Procedure Card for IDenta Ecstasy / MDMA Identification

INSTRUCTIONS

A. Remove sampler from the top of the IDenta test unit.

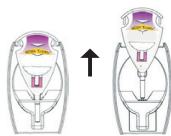

B. If the suspected substance is a tablet, twist applicator tip into tablet, allowing some substance to stick to tip.

* If the suspected substance is a powder, press sampler's adhesive tip onto powder, allowing some material to stick to tip.



C. Return sampler to the test unit and press firmly to lock.
Warning: Do not continue to the next step until sampler is completely locked into place.

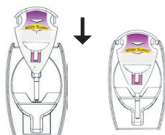

D. **With thumb and forefinger**, firmly press Chamber 1 until ampoule breaks.



E. Gently shake test unit for a few seconds.



* If a violet color develops, MDMA/Ecstasy is present.



Note: color will darken with time.

Proceed to acid dilution step - whether or not color appeared

ACID DILUTION

F. **With thumb and forefinger**, firmly press Chamber 2 until ampoule breaks.



G. Shake test unit gently (for acid dilution).
Wait 5 minutes!



H. **With thumb and forefinger**, firmly press Chamber 3 until ampoule breaks.



I. Shake gently (for completion of acid dilution).



Window of test unit will warm up- this is a normal part of the acid dilution process.

Important: As a precaution, eye protection should be worn, In case of eye or skin contact rinse immediately with water.